

KNIPEX Cobra® QuickSet

FULLY OPEN – PUSH – GRAB



Additional fast adjustment on the workpiece by sliding the pliers handle

- combines the proven, reliable catching of the hinge bolt with an additional push on function which makes it easier to work in very confined and inaccessible areas
- adjustment directly on the workpiece is possible by simply sliding the pliers handle
- the hinge bolt locks itself reliably with the first workload. The gripping width of the pliers is then fixed and can only be adjusted by pressing the button
- the hinge bolt must be released by pressing the button and the pliers must be completely opened once to activate the QuickSet function again.



Press the button – open pliers completely

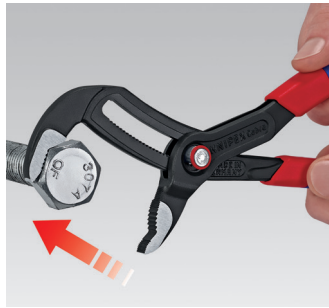

Position jaw – simply slide and close pliers

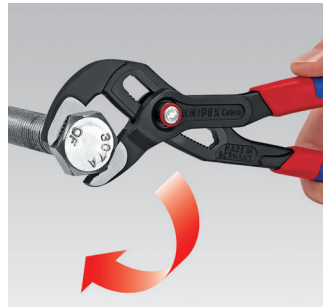

The hinge bolt locks itself with the first workload



QuickSet



Cobra® QuickSet – Push-button

Proven Cobra® functions

- self-locking on pipes and nuts: no slipping on the workpiece and low handforce required
- fine adjustment for optimum adaptation to different sizes of workpieces and a comfortable handle width
- opening at the touch of a button apart from the workpiece
- good access to the workpiece due to slim size of head and joint area
- gripping surfaces with special hardened teeth, teeth hardness approx. 61 HRC: high wear resistance and stable gripping
- box-joint design: high stability due to double guide
- reliable catching of the hinge bolt: no unintentional shifting
- guard prevents operators' fingers being pinched

Article No.	EAN 4003773-	↔ mm		∅ Inch	∅ mm	mm	Adjustment positions	g
87 21 250	072775	250		2	50	46	25	335
87 22 250	077794	250		2	50	46	25	364

KNIPEX-Werk C. Gustav Putsch KG

Oberkamper Straße 13
42349 Wuppertal
Germany

Tel.: +49 (0) 202 – 47 94-0
Fax: +49 (0) 202 – 47 50 58

info@knipex.de
www.knipex.de

Product video



Your Dealer